



kamptal

9 Reihenhäuser



RHA Gars VI Thomas Ecker Straße

- Miete mit Kaufoption
- Wohnnutzfläche ca. 104 m² bzw. 115 m² mit 4 bzw. 5 Zimmer
- Massivbauweise
- HWB_{Ref,SK} von 36,4 kWh/m²a
- Fußbodenheizung
- Fernwärmeanschluss
- PV - Anlage
- Terrasse und Eigengarten
- 1 PKW Stellplatz im Carport

Unser Verkaufsteam
berät sie gerne!

02982 / 3111

MES Real Estate
Services GmbH

Architektur
Ausschreibung
Immobilienbewertung

www.kamptal-gbv.at

LAGEPLAN

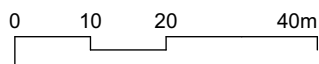
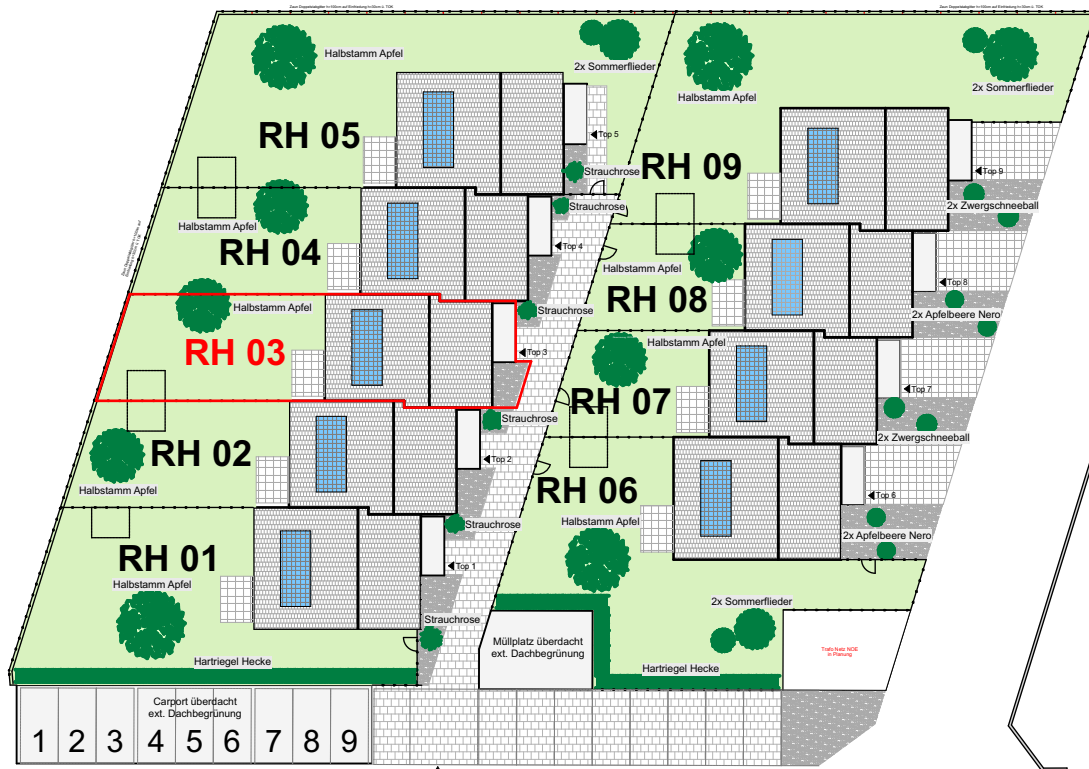

Maßstab 1:500



MES Real Estate Services GmbH
Architektur · Ausschreibung · Immobilienexpertise
Mariahilfer Strasse 41-43
1060 Wien
Mail: office@mes.at
Tel.: +43 1 585 01 35 10

RH 3 TYP B ÜBERSICHT

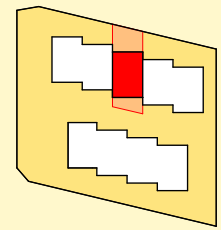

ÜBERSICHT LAGEPLAN

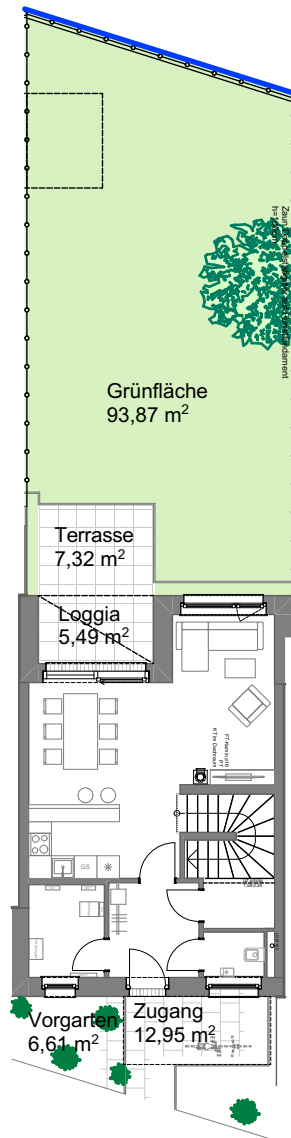

FLÄCHENERMITTLUNG AUSSENANLAGEN

Terrasse	7,32 m ²
Loggia	5,49 m ²
Grünfläche	93,87 m ²
Vorgarten	6,61 m ²
Zugang	12,95 m ²

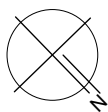
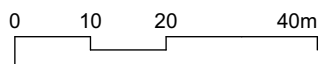

Maßstab 1:200

RH 3 TYP B ERDGESCHOSS

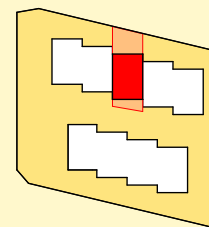

ÜBERSICHT LAGEPLAN

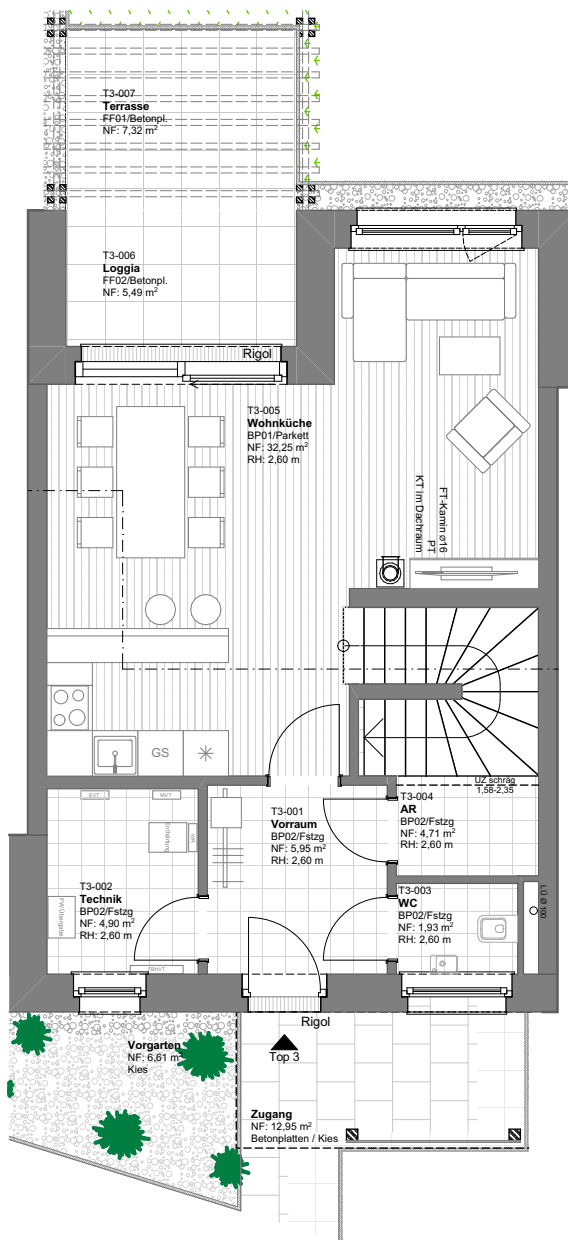

NUTZFLÄCHENERMITTLUNG ERDGESCHOSS

Vorraum	5,95
Wohnküche	32,25
Abstellraum	4,71
Technik	4,90
WC	1,93
Summe	49,74m²

NUTZFLÄCHENERMITTLUNG OBERGESCHOSS

Vorraum	5,08
Zimmer 1	13,53
Zimmer 2	13,39
Zimmer 3	13,50
Bad	8,45
Summe	53,95m²

Summe **103,69m²**

Loggia	5,49m ²
Terrasse	7,32m ²
Vorgarten	6,61m ²
Zugang	12,95m ²

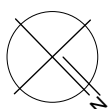
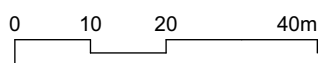

Maßstab 1:100

RH 3 TYP B OBERGESCHOSS

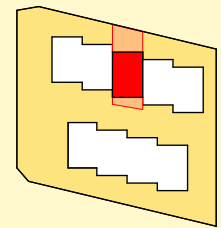

ÜBERSICHT LAGEPLAN

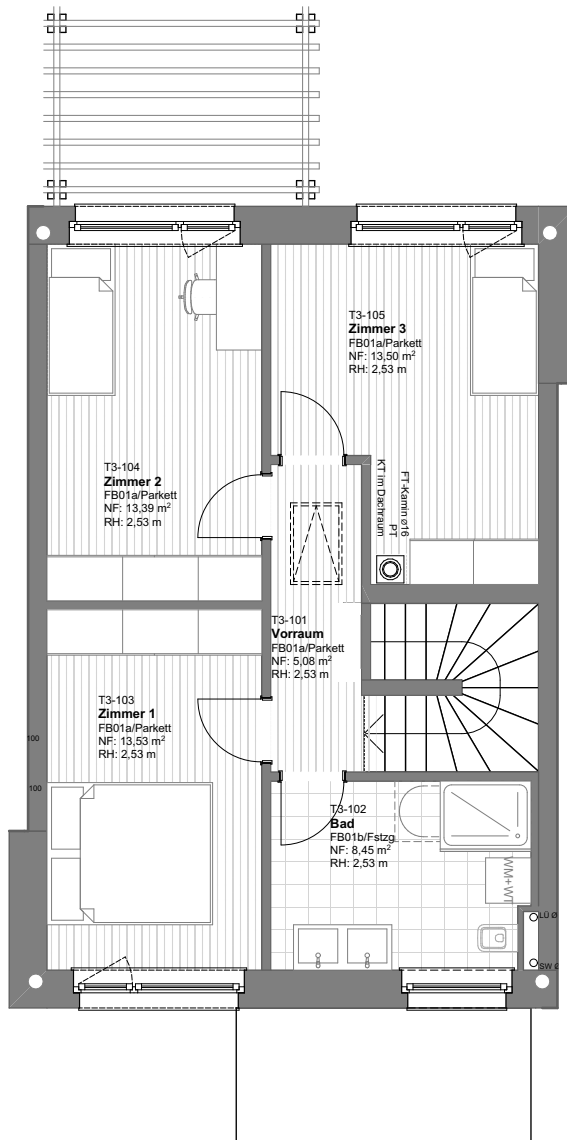

NUTZFLÄCHENERMITTLUNG ERDGESCHOSS

Vorraum	5,95
Wohnküche	32,25
Abstellraum	4,71
Technik	4,90
WC	1,93
Summe	49,74m²

NUTZFLÄCHENERMITTLUNG OBERGESCHOSS

Vorraum	5,08
Zimmer 1	13,53
Zimmer 2	13,39
Zimmer 3	13,50
Bad	8,45
Summe	53,95m²

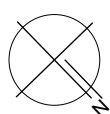
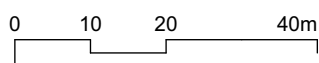





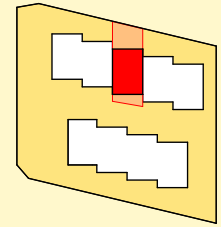















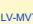

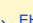
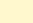

Maßstab 1:100

RH 3 TYP B ERDGESCHOSS ELEKTROPLAN

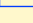
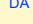

ÜBERSICHT LAGEPLAN

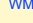
LEGENDE

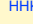
-  DECKENAUSLASS
-  WANDAUSLASS
-  EIN- & AUSSCHALTER
-  EIN- & AUSSCHALTER MIT KONTROLLICHT
-  WECHSELSCHALTER
-  WECHSELSCHALTER
-  SCHUKOSTECKDOSE
-  SCHUKOSTECKDOSE ZWEIFACH
-  SCHUKOSTECKDOSE DREIFACH
-  SCHUKOSTECKDOSE VIERFACH
-  TELEFONSTECKDOSE
-  ANTENNENSTECKDOSE
-  AUSLASS E-HERD 400V
-  AUSLASS ABLUFTVENTILATOR
-  GLOCKE
-  BEWEGUNGSMELDER
-  KLINGELTASTER
-  TASTER
-  WANDAUSLASS AUSSEN
-  DA DUNSTABZUGSHAUBE
-  GS GESCHIRRSPÜHLER
-  KS KÜHLSCHRANK
-  KD KLAPPDECKEL
-  WM WASCHMASCHINE
-  WT WASCHTROCKNER
-  HHK HANDTUCHHEIZKÖRPER
-  BRANDMELDER MIT BATTERIE
-  RTI RAUMTHERMOSTAT

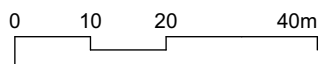
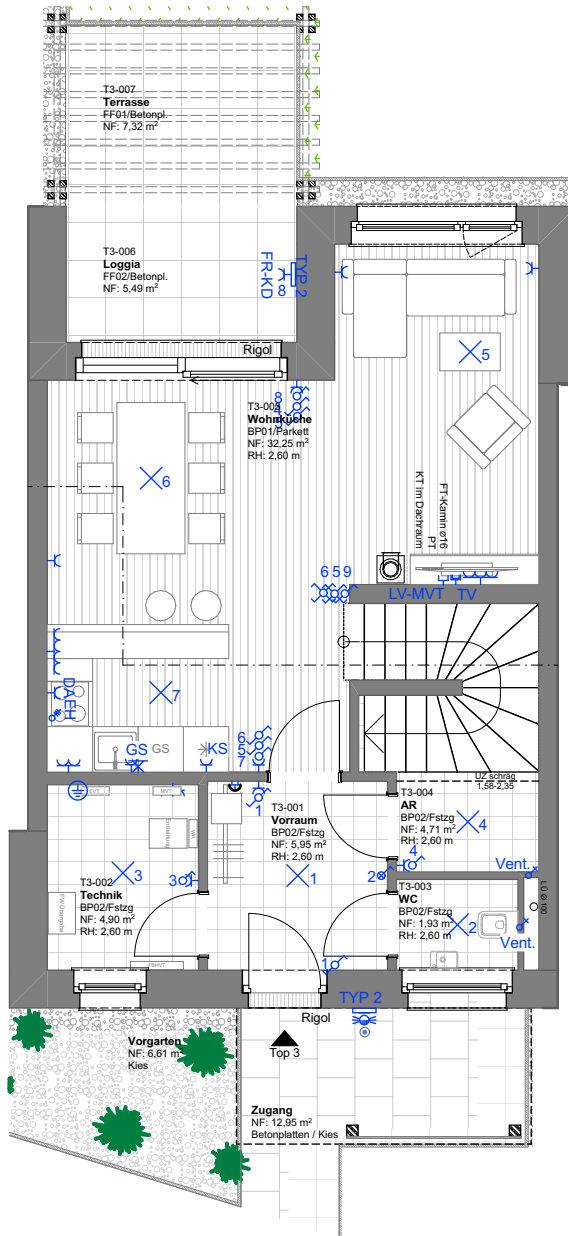

Maßstab 1:100



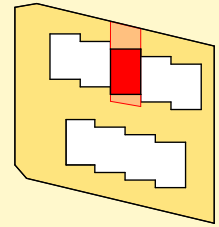



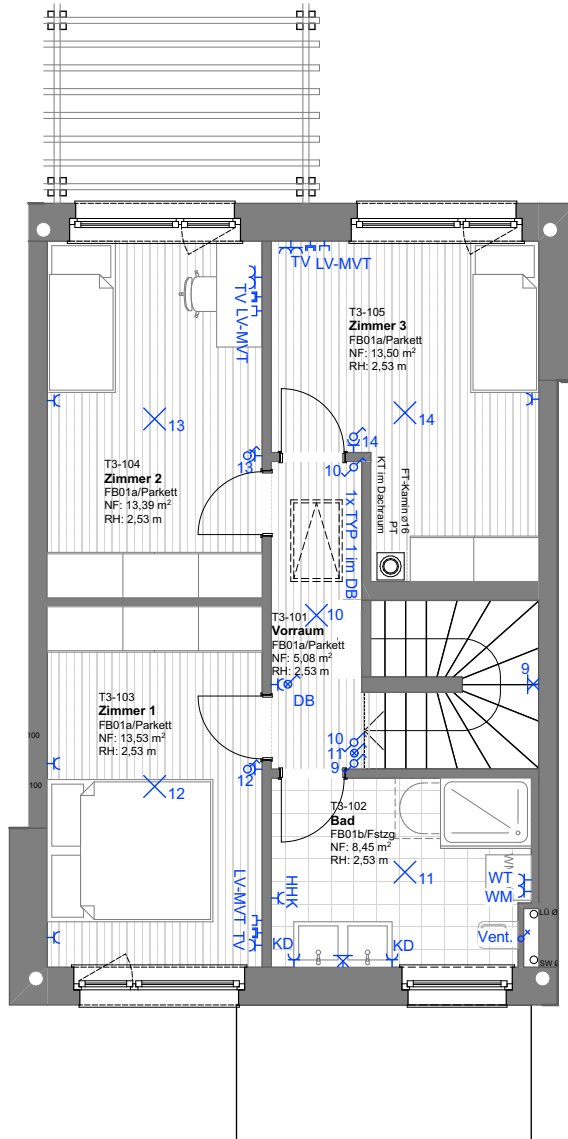













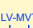

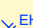
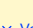

RH 3 TYP B OBERGESCHOSS ELEKTROPLAN

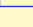
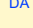
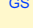

ÜBERSICHT LAGEPLAN



LEGENDE

-  DECKENAUSLASS
-  WANDAUSLASS
-  EIN- & AUSSCHALTER
-  EIN- & AUSSCHALTER MIT KONTROLLICHT
-  WECHSELSCHALTER
-  WECHSELSCHALTER
-  SCHUKOSTECKDOSE
-  SCHUKOSTECKDOSE ZWEIFACH
-  SCHUKOSTECKDOSE DREIFACH
-  SCHUKOSTECKDOSE VIERFACH
-  TELEFONSTECKDOSE
-  ANTENNENSTECKDOSE
-  AUSLASS E-HERD 400V
-  AUSLASS ABLUFTVENTILATOR
-  GLOCKE
-  BEWEGUNGSMELDER
-  KLINGELTASTER
-  TASTER
-  WANDAUSLASS AUSSEN
-  DA DUNSTABZUGSHAUBE
-  GS GESCHIRRSPÜHLER
-  KS KÜHLSCHRANK
-  KD KLAPPDECKEL
-  WM WASCHMASCHINE
-  WT WASCHTROCKNER
-  HHK HANDTUCHHEIZKÖRPER
-  BRANDMELDER MIT BATTERIE
-  RTI RAUMTHERMOSTAT

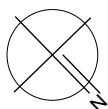
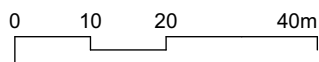

Maßstab 1:100